

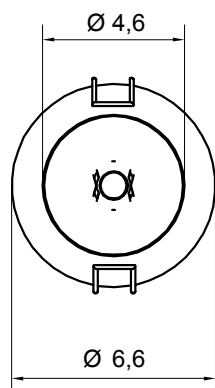

| | | | | | | | | | | |
|---|---|-----------------------------------|------------|-----------|----------|-----------|---------------------|------------------|---------------------|------------------|
| modello: model: | STAR MEDIUM 1 | | | | | | | | | |
| codice: code: | 6710 | | | | | | | | | |
| design: | UT Egoluce | | | | | | | | | |
| anno - year: | 2022 | | | | | | | | | |
| tipologia: typology: | faretto mini trim da incasso mini trim recessed spotlight | | | | | | | | | |
| materiali: | corpo in alluminio, riflettore in polycarbonato metallizzato, schermo in vetro | | | | | | | | | |
| materials: | aluminum structure, metallized polycarbonate reflector, glass screen | | | | | | | | | |
| luce: light: | d'accento o diffusa accent or diffuse | | | | | | | | | |
| sorgente luminosa: light source: | | | | | | | | | | |
| LED code | beams optic | LED color | | | | | | | | |
| /W | /24 /40 /60 | LED 8,9W 17,8V 500mA 1353lm 4000K | | | | | | | | |
| /W/ST | vetro satinato - satin glass | LED 8,9W 17,8V 500mA 1353lm 4000K | | | | | | | | |
| /WW | /24 /40 /60 | LED 8,9W 17,8V 500mA 1303lm 3000K | | | | | | | | |
| /WW/ST | vetro satinato - satin glass | LED 8,9W 17,8V 500mA 1303lm 3000K | | | | | | | | |
| /XW | /24 /40 /60 | LED 8,9W 17,8V 500mA 1244lm 2700K | | | | | | | | |
| /XW/ST | vetro satinato - satin glass | LED 8,9W 17,8V 500mA 1244lm 2700K | | | | | | | | |
| life | > 50.000 h | | | | | | | | | |
| step MacAdam | 3 | | | | | | | | | |
| Indice di Resa Cromatica: Color Rendering Index: | >80 | | | | | | | | | |
| | CRI>90 su richiesta CRI>90 on request | | | | | | | | | |
| grado IP - IP grade: | 40 | | | | | | | | | |
| peso netto - net weight: | 0,20 Kg | | | | | | | | | |
| finiture - finishes: | <table border="0"> <tr> <td>.01 bianco</td> <td>.01 white</td> </tr> <tr> <td>.02 nero</td> <td>.02 black</td> </tr> <tr> <td>.25 dorato satinato</td> <td>.25 golden satin</td> </tr> <tr> <td>.32 nickel satinato</td> <td>.32 satin nickel</td> </tr> </table> | | .01 bianco | .01 white | .02 nero | .02 black | .25 dorato satinato | .25 golden satin | .32 nickel satinato | .32 satin nickel |
| .01 bianco | .01 white | | | | | | | | | |
| .02 nero | .02 black | | | | | | | | | |
| .25 dorato satinato | .25 golden satin | | | | | | | | | |
| .32 nickel satinato | .32 satin nickel | | | | | | | | | |
| marcatura: marking: | CE | | | | | | | | | |
| simboli costruttivi: symbols: | IP40 | | | | | | | | | |

Dimensioni - Dimensions

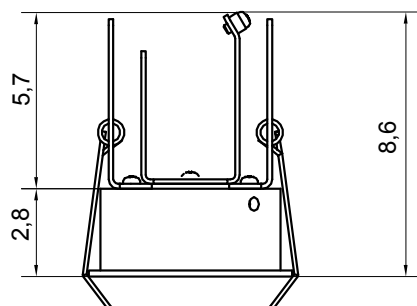

SOLO COLLEGAMENTO IN SERIE - ONLY SERIAL CONNECTION

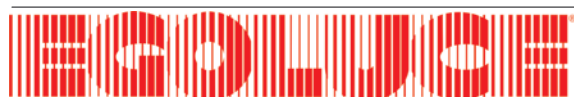

EGOLUCE s.r.l., via I.Newton 12 - 20016 Pero - Milano
 telefono +39 02 339586.1 - fax. +39 02 3535112
 e-mail: info@egoluce.com - http://www.egoluce.com

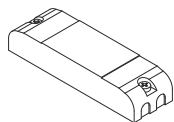
LED DRIVERS in corrente continua
LED DRIVERS constant current**0127****LED driver**
IN: 100 - 240V
OUT: 500 mA
1 COB LED

11,6 x 3,4 x 2 cm 4 cm

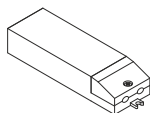
0147/COB**LED driver**
IN: 220 - 240V
OUT: 500 mA
1-2 COB LED

12,5 x 3,8 x 2,4 cm 4,2 cm

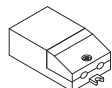
0149/COB**LED driver**
IN: 220 - 240V
OUT: 500 mA
1 COB LED

7,6 x 3,9 x 2,2 cm 4,2 cm

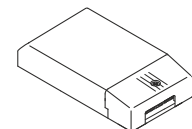
0169/50**Multipower LED driver**IN: 220 - 240V
OUT: 500mA
1-3 COB LED

13 x 7,5 x 3 cm 8,5 cm

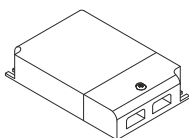
DRIVERS DIMMERABILI in corrente continua
DIMMABLE LED DRIVERS constant current**0129 Dimmer LED**
Multipower dimmable driverIN: 110 - 240V
OUT: 500 mA
1-2 COB LED

10,5 x 7 x 2,2 cm 7,2 cm SELV

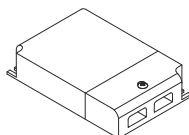
0129/DALI Dimmer LED**Multipower dimmable driver**IN: 110 - 240V
OUT: 500 mA
1-2 COB LED

10,5 x 7 x 2,2 cm 7,2 cm SELV

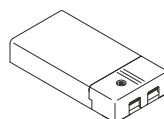
0141/DALI**LED driver**IN: 110 - 240V
OUT: 500 mA
1-2 COB LED

11,1 x 5,2 x 2,5 cm 5,5 cm

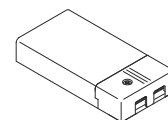
0141/DIM**LED driver**IN: 110 - 240V
OUT: 500 mA,
1-2 COB LED

Versione PUSH non sincronizzabile - PUSH version not synchronizable

11,1 x 5,2 x 2,5 cm 5,5 cm

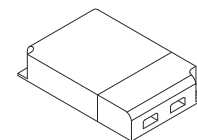
0145 Dimmer LED Maxi**Multipower dimmable driver**IN: 110 - 240V
OUT: 500 mA
1-3 COB LED

12,3 x 8 x 2,2 cm 8,4 cm SELV

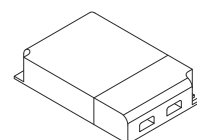
0145/DALI Dimmer LED Maxi**Multipower dimmable driver**IN: 110 - 240V
OUT: 500 mA
1-3 COB LED

12,3 x 8 x 2,2 cm 8,4 cm SELV

0133

Cavo di sincronizzazione per dimmer LED

Synchronization cable for dimmer LED

(art. 0129 - art. 0129/DALI - art. 0145 - art. 0145/DALI)



L 150 cm

0726/DIM**LED dimmer**

TAGLIO DI FASE (IGBT-TRIAC, TRAILING EDGE-LEADING EDGE)

PHASE CUT-OFF (IGBT-TRIAC, TRAILING EDGE-LEADING EDGE)

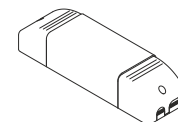
IN: 220 - 240V
OUT: 24V - 20W
500 mA
1-2 COB LED

16,5 x 4,5 x 3,5 cm 5,6 cm IGBT-TRIAC

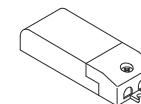
0734/DIM**LED dimmer**Alimentatori elettronici dimmerabili (IGBT-TRIAC) in corrente continua
Direct current dimmable (TRAILING EDGE-LEADING EDGE) electronic driversIN: 220 - 240V
OUT: 500 mA
1 COB LED

8,7 x 3,8 x 2,1 cm 4,2 cm IGBT-TRIAC

UNITA' DI EMERGENZA LED
LED EMERGENCY UNIT**0115/EM****LED Emergency Unit**

Kit Inverter + Battery + LED indicator

15,5 x 5,2 x 2,5 cm + 80 cm + 13,5 x 4,5 x 2,3 cm

EGOLUCE s.r.l., via I. Newton 12 - 20016 Pero - Milano
telefono +39 02 339586.1 - fax. +39 02 3535112
e-mail: info@egoluce.com - http://www.egoluce.com